

SKAMOTEC 225

Fireplace Building Board



www.skamol.com



SKAMOTEC 225 is a lightweight non-combustible board that provides total fire protection for residential and commercial buildings.

With an excellent R-value, high mechanical strength and low thermal conductivity, this material is ideally suited for building fireplace surrounds.

The advantage of Skamotec is, it eliminates the use of traditional frame construction; making it easier and faster to install, for labour-saving efficiency.

Performance Benefits

- Fire protection; non-combustible
- Thermal resistance R-value = 2.38
- Maximum service temperature 1832 °F
- Ease of installation; lightweight and rigid
- Easy to shape with ordinary woodworking tools
- Ideal for renovation additions and new construction
- Mould protection
- Environmentally friendly

Physical Properties

Property	Value
Thermal resistance –“R”	R-value = 2.38 (per 1 inch of thickness) (RSI-value = 0.42)
Thermal conductivity – “k”	0.42 BTU x in/(sq ft x hr x °F) 0.06 W/(m x K)
Non-combustible test – In accordance with ASTM E-136-09	See Intertek Testing Services – Report No. 3178573
Density , dry (lb/ft ³)	14
Compression strength (lb/in ²)	377
Maximum service temperature	1832 °F
Quality certification	ISO 9001:2008

Product Data

Material

Calcium silicate

Weight

1.16 lb/ft² @ 1" thickness

Sizes

Width x Length (in)	Thickness (in)
24 x 39	1, 1 3/16, 1 1/2, 2, 3, 4
39 x 48	1, 1 3/16, 1 1/2, 2
48 x 96	1, 1 3/16, 1 1/2, 2

SKAMOTEC 225

Fireplace Building Board

Ease of installation

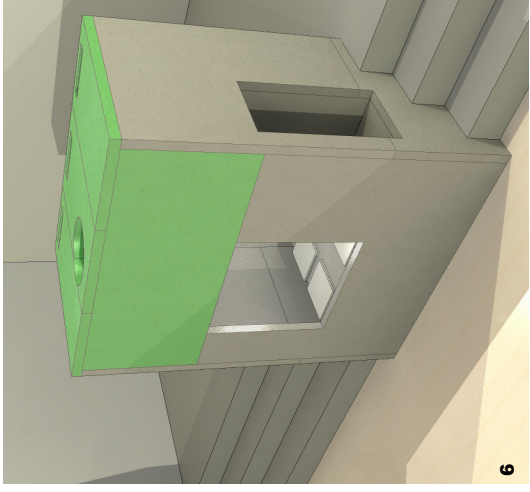
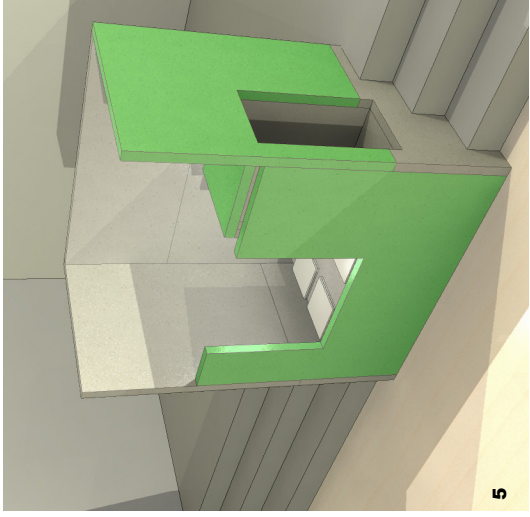
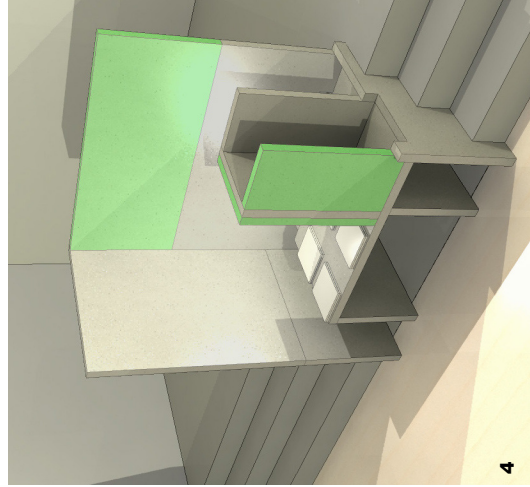
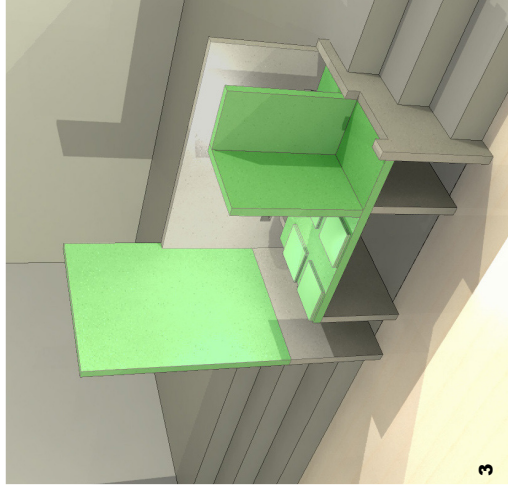
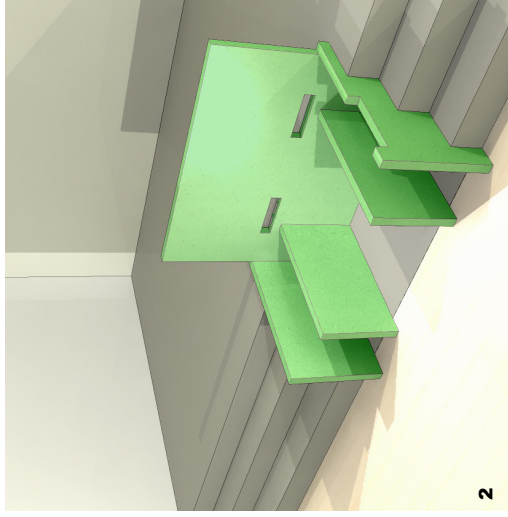
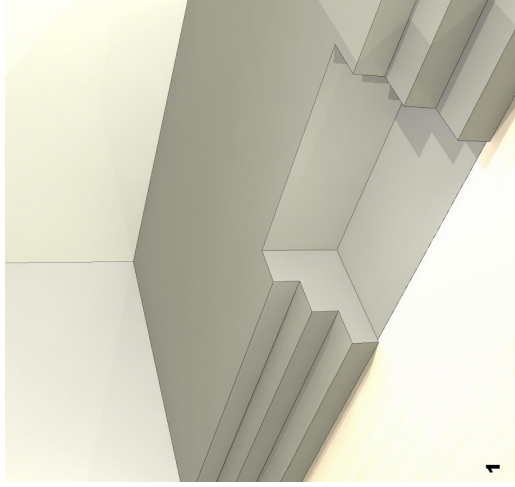

Local Installation requirements

This product is intended for interior installations in residential and commercial buildings. Consult your local general contractor, fireplace builder or chimney sweep to ensure that this installation meets local building, fire codes and standards.